



## Planning Committee B

22/02198/FUL

4 Government House Road

### PLANS TO INSTALL DRIVE GATES

Gates shown in red will be 2 meters tall timber gates running roughly the width of the drive at 3.3 meters

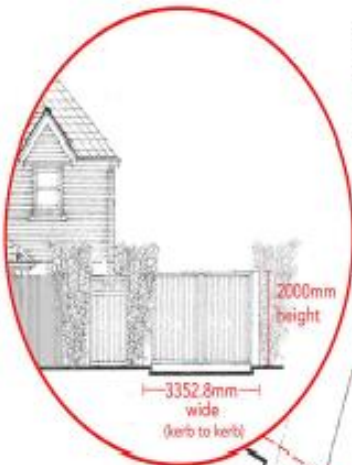

3.1 m distance from Water Mains

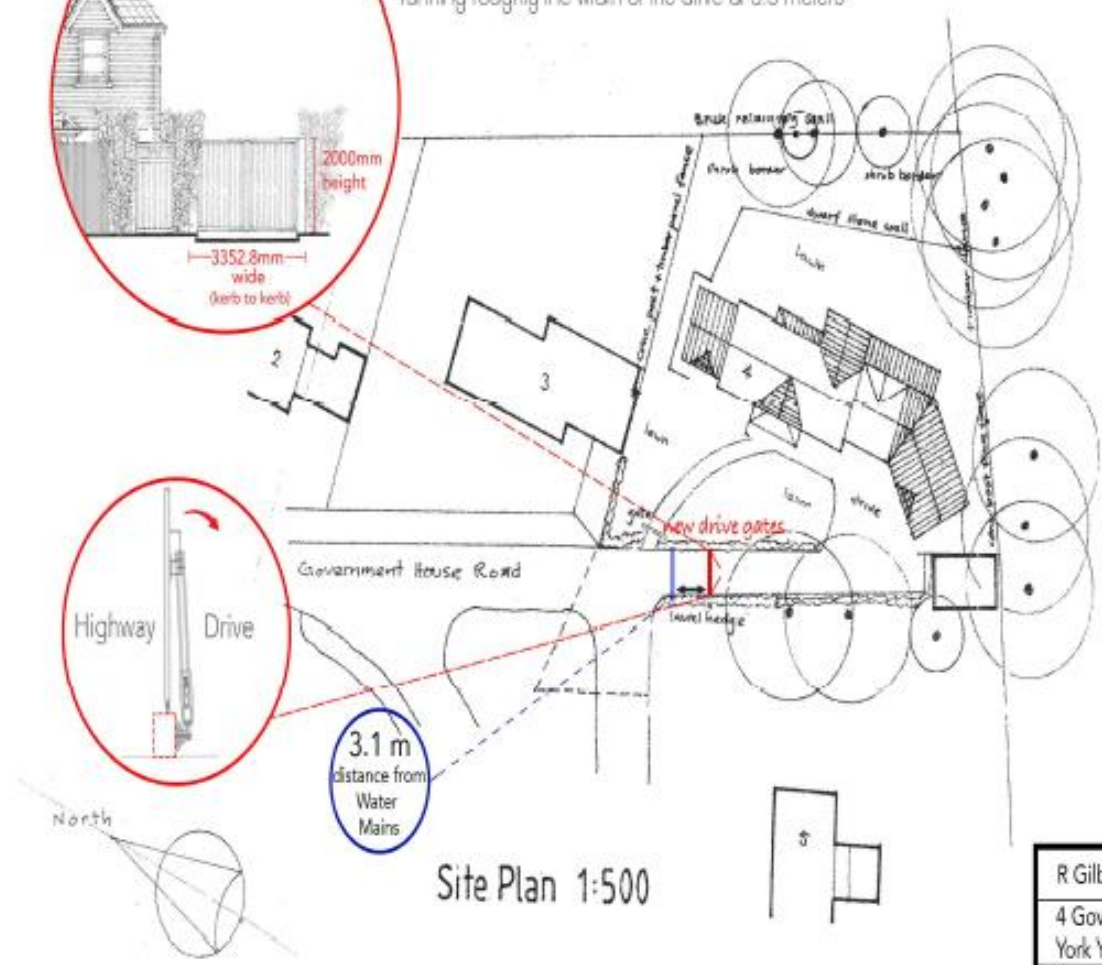

Site Plan 1:500

R Gilbert-Cornish
4 Government House Road York YO306LU
Site plan with proposed entrace gates. (Amended)
Scale 1:500